

York County Shore

Lancaster County Shore

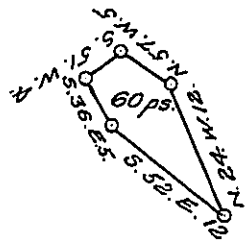

A Draught of an Island situate in the river Susquehanna in Manor Township Lancaster County Called Gutter Island Oppisite to land late Philip Sowers decd on the Lancaster Shore and oppisite the lands of Jacob Musser on the York shore about three perches to the Westward of Mussers large Island and about half a mile above Fry's falls, Containing sixty perches Strict Measure surveyed in pursuance of ^a Warrant dated the 26th day of July A.D. 1814 granted to Peter Kline & George Kline.

John Reist D.S.

To Jacob Spangler Esq.
Surveyor General.

IN TESTIMONY that the above is a copy of the original remaining on file in the Department of Internal Affairs of Pennsylvania, made conformably to an Act of Assembly approved the 16th day of February 1833, I have hereunto set my hand and caused the Seal of said Department to be affixed at Harrisburg, this twenty first day of January 1908.

Henry Hoover
Secretary of Internal Affairs.